

A - AREA STATEMENTS	
1. AREA OF PLOT (AS PER 7/12) 7900.00 + 600.00 =	13300.00sq.m.
2. DEDUCTION FOR	
(a) ROAD ACQUISITION AREA	
(b) PROPOSED ROAD	
(c) ANY RESERVATION	
(TOTAL A + B + C)	
3. NET GROSS AREA OF PLOT (1 - 2)	13300.00sq.m.
4. DEDUCTION FOR	
(a) RECREATIONAL OPEN SPACE AS PER REGULATION NO. 13.3	
TOTAL OPEN SPACE	1331.00 SQ.M.
(b) INTERNAL ROADS.	3336.00 Sq.m.
(c) TOTAL (A + B)	4667.00 Sq.m.
5. NET AREA OF PLOTS (3 - 4c)	8633.00 Sq.m.
6. L.I.G PLOT AREA (MINIMUM 20% OF 8633.00 Sq.m.)	1726.60 Sq.m.
7. M.I.G PLOT AREA (MINIMUM 10% OF 8633.00 Sq.m.)	863.30 Sq.m.

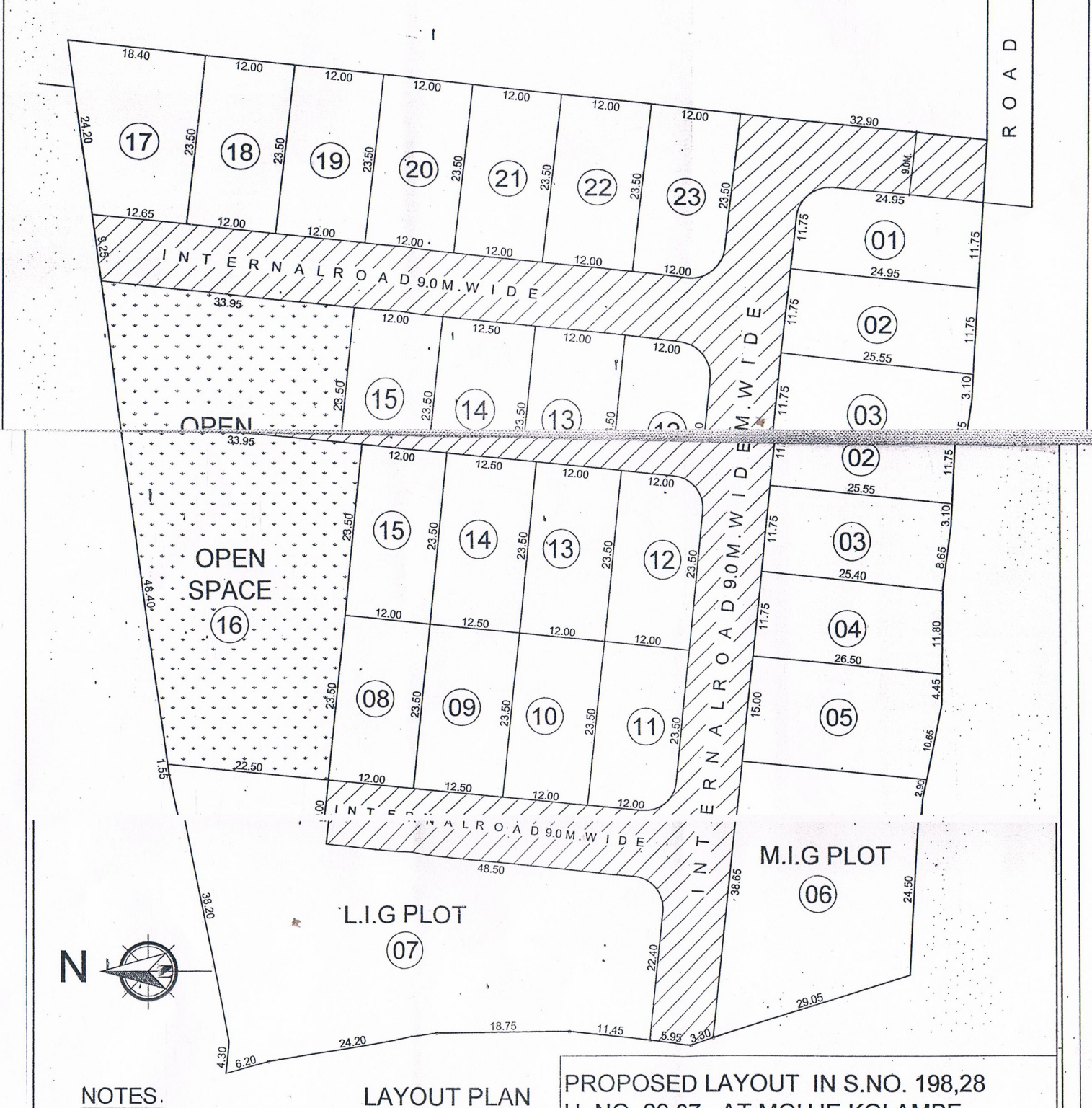
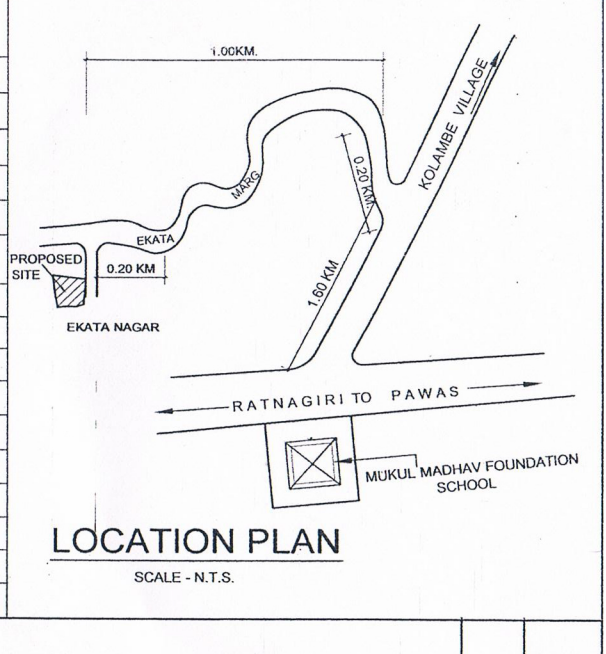

**NOTES.**  
 ■ ALL DIMENSIONS ARE IN METER.  
 ■ PLOT BOUNDARY SHOWN THUS   
 ■ LAYOUT PLOTS BOUNDARY SHOWN THUS

**LAYOUT PLAN**  
 SCALE - 1:500

**PROPOSED LAYOUT IN S.NO. 198,28 H. NO. 29,07 AT MOUJE KOLAMBE, TAL.& DIST. RATNAGIRI.**

OWNER'S NAME & SIGNATURE :

PLOT AREA DETAILS (PLOT NO - 01 TO 23)			
PLOT NO	PLOT AREA	PLOT NO	PLOT AREA
01	289.00 SQ.M.	16 (O.S.)	1330.00 SQ.M.
02	297.00 SQ.M.	17	365.00 SQ.M.
03	299.00 SQ.M.	18	282.00 SQ.M.
04	305.00 SQ.M.	19	282.00 SQ.M.
05	398.00 SQ.M.	20	282.00 SQ.M.
06 M.I.G PLOT	865.00 SQ.M.	21	282.00 SQ.M.
07 L.I.G PLOT	1846.00 SQ.M.	22	282.00 SQ.M.
08	282.00 SQ.M.	23	282.00 SQ.M.
09	294.00 SQ.M.	TOTAL =	9963.00 SQ.M.
10	282.00 SQ.M.	INTERNAL ROADS	3336.00 SQ.M.
11	281.00 SQ.M.	TOTAL AREA =	13300.00 SQ.M.
12	281.00 SQ.M.		
13	282.00 SQ.M.		
14	294.00 SQ.M.		
15	282.00 SQ.M.		

ENGINEER :

**MILIND R. YADAV**  
 D.C.E.  
 Architectural Designer  
 & Civil Engineer  
 Mob : 942...36

FOR APPROVAL